



pure indoor living



WARM AND COOL MIST *HUMIDIFIER WITH DIGITAL HUMIDISTAT*

MODEL: BUL9100-CN

Instruction Leaflet

Read instructions before operating. Retain for future reference.



Questions? Comments? Call 1-800-253-2764 in North America.

PLEASE READ AND SAVE THESE IMPORTANT SAFETY INSTRUCTIONS

When using electrical appliances, basic safety precautions should always be followed to reduce the risk of fire, electric shock, and injury to persons, including the following:

1. Read all instructions before using the appliance.
2. To avoid fire or shock hazard, plug the appliance directly into a 120V AC electrical outlet.
3. Keep the cord out of heavy traffic areas. To avoid fire hazard, NEVER put the cord under rugs or near heat registers.
4. DO NOT place humidifier near heat sources such as stoves, radiators, and heaters. DO locate your humidifier on an inside wall near an electrical outlet. The humidifier should be at least 4 inches (10 cm) away from the wall for best results.
5. NEVER place humidifier in an area where it is accessible to children. NEVER use humidifier in a closed room, particularly where a child may be sleeping, resting, or playing (a closed room may result in excessive humidity).
6. **WARNING:** Do not attempt to refill humidifier without first unplugging the unit from its electrical outlet. Failure to heed this warning may cause personal injury. Be sure to unplug the unit by pulling on the plug and not the cord.
7. Never place anything over moisture outlet when the unit is running.
8. NEVER drop or insert any object into any openings.
9. DO NOT operate any appliance with a damaged cord or plug, after the appliance malfunctions, or if it has been dropped or damaged in any manner. Return appliance to manufacturer for examination, electrical or mechanical adjustment, or repair.
10. Use appliance only for intended household use as described in this manual. Any other use not recommended by the manufacturer may cause fire, electric shock, or injury to persons. The use of attachments not recommended or sold by the manufacturer may cause hazards.
11. DO NOT use outdoors.
12. Always place humidifier on a firm, flat, level surface. A waterproof mat or pad is recommended for use under the humidifier. NEVER place it on a rug or carpet, or on a finished floor that may be damaged by exposure to water or moisture.
13. DO NOT allow the Moisture Outlet to directly face the wall. Moisture could cause damage, particularly to wall paper.
14. Humidifier should be unplugged when not in use.
15. NEVER tilt, move, or attempt to empty unit while it is operating. Shut off and unplug before removing the water tank and moving the unit.
16. This humidifier requires daily and weekly maintenance to operate appropriately. Refer to daily and weekly cleaning procedures. Use only cleaners and additives recommended by the manufacturer.
17. NEVER use detergents, gasoline, glass cleaner, furniture polish, paint thinner, or other household solvents to clean any part of the humidifier.
18. Excessive humidity in a room can cause water condensation on windows and some furniture. If this happens, turn the humidifier OFF.
19. Do not use humidifier in an area where humidity level is in excess of 50%. Use a hygrometer, available at your local retailer or through the manufacturer, to measure the humidity.
20. DO NOT attempt to repair or adjust any electrical or mechanical functions on this unit. Doing so will void your warranty. The inside of the unit contains no user serviceable parts. All servicing should be performed by qualified personnel only.

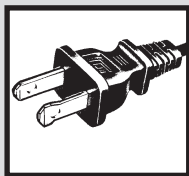

THIS APPLIANCE HAS A POLARIZED PLUG (one blade is wider than the other). To reduce the risk of electric shock, this plug is intended to fit in a polarized outlet only one way. If the plug does not fit fully in the outlet, reverse the plug. If it still does not fit, contact a qualified electrician to install the proper outlet.

DO NOT ATTEMPT TO MODIFY THIS PLUG OR DEFEAT THIS SAFETY FEATURE IN ANY WAY.

FEATURES - OPERATIONS

21. Never place housing under water flow or immerse in liquids.
22. Do not plug in the cord with wet hands: electric shock could result.
23. Do not pour water in any openings other than the water tank.
24. To prevent damage to surfaces, do not place humidifier under overhanging surfaces.
25. NEVER operate unit without water in the tank.
26. Do not move unit after it has been used until unit cools completely.
27. Use both hands when carrying full tank of water.

PLEASE READ AND SAVE THESE IMPORTANT SAFETY INSTRUCTIONS

CONSUMER SAFETY INFORMATION

NOTE: This is an electrical appliance and requires attention when in use.

NOTE: If moisture forms on the walls or windows of the room, turn off the humidifier. The room already has plenty of humidity and additional moisture may cause damage.

NOTE: DO NOT block air inlet or outlet.

Cord and Plug Installation Safety Instructions:

The length of cord used on this appliance was selected to reduce the hazards of becoming tangled in, or tripping over a longer cord. If a longer cord is necessary an approved extension cord may be used. The electrical rating of the extension cord must be equal to or greater than the rating of the humidifier (refer to the rating information placed on the humidifier). Care must be taken to arrange the extension cord so that it will not drape over the countertop or tabletop where it can be pulled on by children or accidentally tripped over.

ICES STATEMENT

This apparatus meets all requirements of the Canadian Interference-Causing Equipment Regulations. This Class B digital apparatus complies with Canadian ICES-001.

HOW ULTRASONIC WORKS:

An ultrasonic transducer atomizes water, producing refreshing visible cool or warm mist.

NOTE: A humidity level below 20% can be unhealthy and uncomfortable. The recommended humidity level is between 40%-50%.

FILLING INSTRUCTIONS

1. Be sure the humidifier is switched off.
2. Select a location for your humidifier on a flat level surface about 4 inches (10 cm) away from the wall. DO NOT place the humidifier on a finished floor or near furniture which can be damaged by too much moisture or water. Place on a moisture resistant surface.
3. Remove the tank from the main housing.
4. Bring the tank to the sink, twist off the tank cap by turning counterclockwise. Fill tank with cool, fresh tap water. DO NOT fill with warm water as this may cause leaking. Replace the cap on tank FIRMLY.
5. Place tank back onto the base. The tank will immediately begin to empty into the base.
6. Plug the humidifier into a 120V electrical outlet.

OPERATING INSTRUCTIONS

Power Button

1. Press the Power Button to turn the humidifier on; the LCD Display shows the room humidity level.
NOTE: The display range is 30% - 90%. If your room humidity level falls below 30%, the unit will still display 30. If your room humidity level rises above 90%, the unit will continue to display 90.
2. Once the unit is turned on, it begins to run at the Cool Mist and High Speed settings. The **Cool Mist icon** (❄️) and **High speed setting** (🌀) will illuminate on LCD display.
3. To switch to Low (1) setting, press the **Speed Button** (🔽).

FEATURES - OPERATIONS

Figure 1

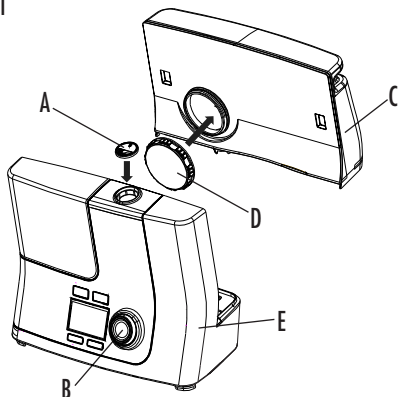

- A. Nozzle
B. Control Panel (see Figure 2 for close-up)
C. Water Tank
D. Tank Cap
E. Humidifier Housing

Figure 2

Control Panel (close-up)

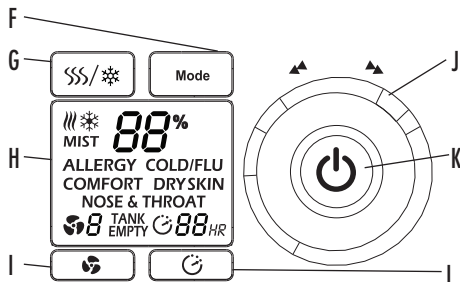

- F. Comfort Select Button
G. Warm/Cool Mist Button
H. LCD Display
I. Speed Button
J. Dial Knob
K. Power Button
L. Timer Button

Warm/Cool Mist Button

Press the **Warm/Cool Mist Button** (☁/❄) to switch between Cool Mist and Warm Mist mode. The corresponding icon (☁ for Warm/❄ for Cool Mist) will illuminate on LCD display to indicate which mode is activated. Cool Mist and Warm Mist can operate at all speed settings. Press the **Speed Button** (🌀) to switch between **High (2)** and **Low (1)** settings.

NOTE: For optimal warm mist output allow up to 20 minutes of run time after selecting the warm mist function.

Comfort Select Button (5 Comfort Modes)

The humidifier is designed with 5 comfort modes; you may select the one which suits your need. Press the **Mode Button** to activate the function, and then turn the **Dial Knob** (▲/▼) to cycle through the 5 comfort levels and select your preferred mode; the selected mode will illuminate on LCD display:

- **ALLERGY**
- **COLD/FLU**
- **COMFORT**
- **DRY SKIN**
- **NOSE & THROAT**

Digital Humidistat Control

Your humidifier is equipped with a digital humidistat that allows you to set your humidifier to your desired comfort level. To preset a precise comfort level, turn the **Dial Knob** (▲/▼) to adjust the humidity level ranging from **35%** to **60%** or "Stay On" setting for constant humidity. The LCD Display will show the selected humidity level for 5 seconds and then change back to show the room humidity. When the room humidity level rises above the set humidity, the humidifier will stop. When the room humidity level drops below the set humidity, the humidifier will turn on automatically to maintain the preset humidity level.

NOTE: To shut the humidifier off at any setting, press the **Power Button** (⏻). The humidistat has memory. This means that when you turn the unit back on, it will be at the last humidity setting before the humidifier is turned off. However, if the humidifier is unplugged, the digital humidistat will no longer remember the previous humidity setting. You will need to reset the digital humidistat if the humidifier is unplugged.

FEATURES - OPERATIONS

CAUTION: DO NOT move the humidifier with water in the tank or the humidifier base. The moving action of the water may activate the water tank's release nozzle and overflow the humidifier base. This may cause the humidifier to function intermittently, or stop emitting mist. Should this occurs, simply remove the excess water from the humidifier base.

NOTES:





- **High** setting will produce the maximum moisture level and **Low** setting will produce the longest run time and quieter performance.
- When the humidifier runs out of water, the transducer and fan will automatically shut off.

Tank Empty

Once the tank is empty, **TANK EMPTY** will illuminate in the LCD display, and the humidifier will shut off automatically. Unplug the humidifier from the electrical outlet. Before refilling, empty any residual water from the base and the tank (follow the daily maintenance instructions).

Timer

Your humidifier is equipped with 24-Hour Auto Shut-off Timer feature. This allows you to program your humidifier to shut off automatically after running for a defined time interval.

1. Press the **Timer Button** () once. The "00" next to **HR** icon will begin to blink.
2. Press the **Timer Button** () to select your desired time interval for the humidifier to shut off automatically after 8, 12, 16 or 24 hours.
3. The **Timer icon** () will appear on the LCD Display to indicate that the Timer is active.
4. To cancel the Timer feature, press the **Timer Button** () to select "00" **HR**.

CLEANING AND MAINTENANCE INSTRUCTIONS

The following maintenance procedures must be routinely followed in order to ensure proper, efficient operation of your humidifier. The unit will not work properly if not cleaned regularly.

When the unit is in use, daily and weekly maintenance is recommended. Regular weekly cleaning prevents scale buildup on the heating element and tray. It also prevents micro-organisms from growing on the tray and tank. This ensures that maximum efficiency will be achieved.

We cannot over-emphasize how essential proper cleaning is to the maintenance and continued use of your unit and to the avoidance of algae or bacteria build-up.

Daily Maintenance:

1. Before cleaning, switch off the humidifier and unplug the unit from the electrical outlet. Allow the unit to cool down before cleaning.
2. Remove the water tank from the humidifier and place in sink or tub.
3. Drain any remaining water and rinse thoroughly to remove any sediment or dirt. Wipe clean and dry with a clean cloth or paper towel.
4. Refill with cool tap water. Do not overfill.

FEATURES - OPERATIONS CLEANING / MAINTENANCE

Weekly Maintenance

Remove Scale:

1. Repeat steps 1-3 in the Daily Maintenance section.
2. Clean all surfaces with a soft brush (provided - see Figure 3). Lift door on left bottom side of humidifier to access transducer. Use brush provided to gently clean transducer (See Figure 3). Remove the scale by wiping the entire base with a cloth dampened with undiluted white vinegar.
3. Rinse with clean warm water to remove scale and the white vinegar solution before beginning to disinfect the tank.

Disinfect tank:

1. Fill humidifier tank 1/2 full with water and 1/2 tablespoon of chlorine bleach.
2. Let the solution stand for 20 minutes, swishing every few minutes. Wet all surfaces.
3. Empty the tank after 20 minutes, and rinse well with water until the bleach smell is gone. Dry with a clean cloth or paper towel.
4. Refill the water tank with cool water; replace the housing and the water tank. Repeat ALL Operating Instructions.

Figure 3

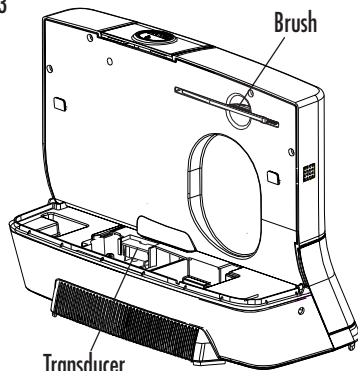

STORAGE INSTRUCTIONS REPLACEMENT ACCESSORIES

STORAGE INSTRUCTIONS

If your humidifier will not be in use for two days or more, follow these instructions.

1. Clean, rinse and thoroughly dry the humidifier as directed in the weekly maintenance section. DO NOT leave any water inside the base.
2. Remove the tank cap. Do not store with the tank cap in place.
3. Place the humidifier in the original carton and store in a cool, dry place.
4. Always clean the humidifier before the next season begins.

REPLACEMENT ACCESSORIES

To order the replacement accessories you can do any of the following:

- Visit your local retailer
- Go to www.bionairecanada.com
- Call Consumer Service at 1-800-253-2764

If you have any questions regarding your product or would like to learn more about other Bonaire® products, please contact our Consumer Service Department at 1-800-253-2764 or visit our website at www.bionairecanada.com.

TROUBLESHOOTING

TROUBLESHOOTING		
Trouble	Probable Cause	Solution
<ul style="list-style-type: none">Water Leaks from Tank.	<ul style="list-style-type: none">Tank rubber ring is missing.Tank cap not tight enough.Tank water is Hot.	<ul style="list-style-type: none">✓ Remove tank cap and replace or reposition ring.✓ Tighten the tank cap.✓ Fill with cool water only.
<ul style="list-style-type: none">Crack in Tank.	<ul style="list-style-type: none">Hot water will cause tank to pressurize.Tanks will crack if hit or dropped.	<ul style="list-style-type: none">✓ Fill with cool water only.✓ Handle tank with care.
<ul style="list-style-type: none">Film on Tank.	<ul style="list-style-type: none">Mineral deposits.	<ul style="list-style-type: none">✓ Clean/disinfect tank as instructed in weekly cleaning instructions.
<ul style="list-style-type: none">Warm mist minimal to none.	<ul style="list-style-type: none">Heating element can take up to 20 minutes to warm.	<ul style="list-style-type: none">✓ Allow up to 20 minutes of run time after selecting the warm mist option.
<ul style="list-style-type: none">Reduced or no mist.	<ul style="list-style-type: none">Scale build up on transducer.	<ul style="list-style-type: none">✓ Clean transducer (refer to the Cleaning and Maintenance Instructions).

FREQUENTLY ASKED QUESTIONS

FREQUENTLY ASKED QUESTIONS

Question	Answer
<ul style="list-style-type: none">• What are the variables that affect run time?	<p>The estimated run time for this humidifier is based on average room conditions. The actual run time of your humidifier is dependent on numerous variables such as:</p> <ul style="list-style-type: none">✓ Air exchange in the room where the humidifier is placed.✓ Room construction of the room where the humidifier is placed.✓ Temperature of the room where the humidifier is placed.✓ Humidity levels in the room where the humidifier is placed.✓ Movement of occupants and the opening and closing of doors in the room where the humidifier is placed.✓ Home furnishings in the room where the humidifier is placed.
<ul style="list-style-type: none">• How do I remove film on water tank?	<ul style="list-style-type: none">✓ See Daily Maintenance instructions. Regular cleaning is recommended.
<ul style="list-style-type: none">• How can I extend the run time?	<ul style="list-style-type: none">✓ Run your unit on the lowest setting.✓ If your unit has electronics, set it to your desired humidity level. The unit will turn on and off, which will extend the run time.✓ Fill the tank all the way full, place it on the base, let the water empty into the base until it stops bubbling, then refill the tank full again. This ensures maximum water capacity and will extend run time.

WARRANTY INFORMATION

1 YEAR LIMITED WARRANTY

Sunbeam Products, Inc. doing business as Jarden Consumer Solutions or if in Canada, Sunbeam Corporation (Canada) Limited doing business as Jarden Consumer Solutions (collectively "JCS") warrants that for a period of one year from the date of purchase, this product will be free from defects in material and workmanship. JCS, at its option, will repair or replace this product or any component of the product found to be defective during the warranty period. Replacement will be made with a new or remanufactured product or component. If the product is no longer available, replacement may be made with a similar product of equal or greater value. This is your exclusive warranty. Do NOT attempt to repair or adjust any electrical or mechanical functions on this product. Doing so will void this warranty. This warranty is valid for the original retail purchaser from the date of initial retail purchase and is not transferable. Keep the original sales receipt. Proof of purchase is required to obtain warranty performance. JCS dealers, service centers, or retail stores selling JCS products do not have the right to alter, modify or any way change the terms and conditions of this warranty.

This warranty does not cover normal wear of parts or damage resulting from any of the following: negligent use or misuse of the product, use on improper voltage or current, use contrary to the operating instructions, disassembly, repair or alteration by anyone other than JCS or an authorized JCS service center. Further, the warranty does not cover: Acts of God, such as fire, flood, hurricanes and tornadoes.

What are the limits on JCS's Liability?

JCS shall not be liable for any incidental or consequential damages caused by the breach of any express, implied or statutory warranty or condition.

Except to the extent prohibited by applicable law, any implied warranty or condition of merchantability or fitness for a particular purpose is limited in duration to the duration of the above warranty.

JCS disclaims all other warranties, conditions or representations, express, implied, statutory or otherwise.

JCS shall not be liable for any damages of any kind resulting from the purchase, use or misuse of, or inability to use the product including incidental, special, consequential or similar damages or loss of profits, or for any breach of contract, fundamental or otherwise, or for any claim brought against purchaser by any other party.

Some provinces, states or jurisdictions do not allow the exclusion or limitation of incidental or consequential damages or limitations on how long an implied warranty lasts, so the above limitations or exclusion may not apply to you.

This warranty gives you specific legal rights, and you may also have other rights that vary from province to province, state to state or jurisdiction to jurisdiction.

How to Obtain Warranty Service

In the U.S.A.

If you have any question regarding this warranty or would like to obtain warranty service, please call 1-800-253-2764 and a convenient service center address will be provided to you.

In Canada

If you have any question regarding this warranty or would like to obtain warranty service, please call 1-800-253-2764 and a convenient service center address will be provided to you.

In the U.S.A., this warranty is offered by Sunbeam Products, Inc. doing business as Jarden Consumer Solutions located in Boca Raton, Florida 33431. In Canada, this warranty is offered by Sunbeam Corporation (Canada) Limited doing business as Jarden Consumer Solutions, located at 20 B Hereford Street, Brampton, Ontario L6Y 0M1. If you have any other problem or claim in connection with this product, please write our Consumer Service Department. **PLEASE DO NOT RETURN THIS PRODUCT TO ANY OF THESE ADDRESSES OR TO THE PLACE OF PURCHASE.**