



pure indoor living



**AIR PURIFIER**

**WITH**



MODEL: BAP9200C-CN

## **Instruction Leaflet**

Read instructions before operating. Retain for future reference.

 Questions? Comments? Call 1-800-253-2764 in North America or visit our website at [www.bionairecanada.com](http://www.bionairecanada.com).

# IMPORTANT SAFEGUARDS

When using electrical appliances, basic safety precautions should always be followed to reduce the risk of fire, electric shock, and injury to persons. These precautions include:

- Read all instructions before using the appliance.
- To avoid fire or shock hazard, plug the appliance directly into a 120V AC electrical outlet.
- If the filter is covered by a bag when shipped: Remove plastic bag before use.
- Keep the cord out of heavy traffic areas. To avoid fire hazard, NEVER put the cord under rugs, near heat registers, radiators, stoves, or heaters.
- To protect against electrical hazards, DO NOT immerse in water or other liquids. Do not use near water.
- Close supervision is necessary when any appliance is used by or near children, or disabled persons.
- Always unplug the air cleaner before moving or cleaning the unit, opening the grill, changing the filters and whenever the unit is not in use. To disconnect the unit, be sure to pull the plug and not the cord.
- NEVER drop or insert any objects into the openings of the unit.
- Do not operate any appliance with a damaged cord or plug. If the motor fan fails to operate or the unit has been dropped or damaged in any manner, return appliance to manufacturer for examination and/or repair.
- Use appliance only for intended household use as described in this manual. Any other use not recommended by the manufacturer may cause fire, electric shock, or injury to persons. The use of attachments not recommended or sold by the manufacturer may cause hazards.
- DO NOT use outdoors. Suitable for Dry Location ONLY.
- NEVER place on a soft surface such as a bed or sofa as this could cause the unit to tip over and block the air inlet or outlet grills.
- Keep unit away from heated surfaces and open flames.
- DO NOT place anything on top of unit.
- DO NOT attempt to repair or adjust any electrical or mechanical functions on this unit. Doing so will void your warranty. The inside of the unit contains no user serviceable parts. All servicing should be performed by Jarden Consumer Solutions or an authorized Jarden Consumer Solutions Service Center.
- **WARNING:** To reduce the risk of fire or electric shock, DO NOT use this air cleaner with any solid-state speed control device.
- Always turn the appliance off before unplugging it.
- NEVER use detergents, gasoline, glass cleaner, furniture polish, paint thinner or other household solvents to clean any part of the air cleaner.
- The ionizer in this appliance produces less ozone than the UL established limits of 50ppb (parts per billion). However, in high concentrations, ozone can be harmful to birds and small pets. To prevent ozone buildup, we suggest using the ionizer in well ventilated areas with the fan on.
- This appliance should only be used in a room with temperatures between 40° F and 110° F.

## PLEASE SAVE THESE IMPORTANT SAFETY INSTRUCTIONS

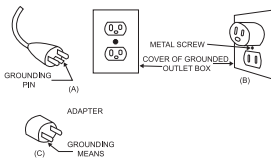

To reduce the risk of electric shock, THIS PRODUCT IS EQUIPPED WITH A 3-PRONG PLUG, a grounding type plug that has a third (grounding) pin. The cord has a plug (A) as shown. An adapter (C) can be purchased for connecting three-blade grounding-type plugs to two slot receptacles (B). The green grounding wire or lug extending from the adapter must be connected to a permanent ground such as a properly grounded outlet box. The adapter should not be used if a three-slot grounded receptacle is available. This plug will only fit into a grounding type power outlet. If the plug does not fit into the outlet, contact qualified electrician to install the proper outlet. This product is for use on 120 volts.

**DO NOT ALTER THE PLUG IN ANY WAY.**

# IMPORTANT SAFEGUARDS - FEATURES

## CORD SAFETY

- The length of cord used on this appliance was selected to reduce tangling and tripping hazards.
- If a longer cord is necessary, an approved extension cord may be used. The electrical rating of the extension cord must be equal to or greater than the rating of the air cleaner (see rating label marked on product).
- Care must be taken to arrange the extension cord so that it will not drape over the countertop or tabletop where it can be pulled on by children or accidentally tripped over.
- If the supply cord is damaged, it must be replaced by the manufacturer, its service agent or similarly qualified persons in order to avoid hazard.

## GET TO KNOW YOUR AIR CLEANER

This unit is compatible with all Aer1™ Filters. This allows you to choose the filter that is just right for you. Below is information on each filter:

**TOTAL AIR** - Advanced Dust Eliminating Technology

**ODOR ELIMINATOR** - 10x the odor fighting power

**ALLERGEN REMOVER** - True HEPA technology improves air quality for allergy sufferers

**ALLERGY PLUS** - True HEPA technology improves air quality for allergy sufferers.

**GERM REDUCING** - True HEPA PLUS Silver infused germ reducing technology, silver coated filter reduces bacteria and viruses from the air stream.

## IONIZER

This appliance has an optional ionizer feature which, when turned on, releases negative ions into outgoing filtered air to help the air purification process.

### What Are Ions?

Ions are tiny particles that carry a positive or negative charge. They exist naturally around us: in the air, water, and ground. Both positive and negative ions are colorless, odorless, and completely harmless.

### How Does The Ionizer Work?

Negative ions help air purification by attaching themselves to very small airborne particles in the room. These particles take on a negative charge and may join with positively charged particles such as dust, pollen, smoke, and pet dander to form larger particles. These larger particles are then more easily captured by the filter system.

### Important Notes:

Your ionizer may produce an occasional popping or cracking sound. This is normal and occurs when a small buildup of ions is discharged.

After extended use, you may notice dust around the grills or front panel. This is caused by negative ions exiting the air outlet, evidence of the ionizer's air cleaning effectiveness. You can remove the dust with a soft brush or clean, damp cloth.

Larger particles may be attracted to positively charged surfaces throughout the home, like walls or floors.

- This may occur more frequently when the filter is nearing the end of its useful product life and unable to capture as many charged particles.
- Excessive amounts of pet dander, dust, or smoke may decrease the life expectancy of the filter(s) and interfere with the ionization process.

To help prevent particles from attracting to surfaces throughout your home:

- You may want to run the ionizer less often.
- Check the condition of filter more frequently.

**CAUTION:** The ionizer in this appliance produces less ozone than the UL established limits of 50ppb. However, in high concentrations, ozone can be harmful to birds and small pets. To prevent ozone buildup, we suggest using the ionizer in well ventilated areas with the fan on.

**IMPORTANT:** Always check the condition of the Aer1™ filter at the recommended intervals and replace filter if necessary (See FILTER REPLACEMENT INSTRUCTIONS). Using the ionizer with dirty filter may result in dirty particles exiting the air cleaner and attracting to walls, carpets, furniture, or other household objects. These dirty particles may prove difficult to remove.

# FEATURES - OPERATIONS

## FILTER CHECK INDICATOR

Your Air Cleaner includes Aer1™ Allergy Plus Filter, specially designed to remove pollen, dust, mold and dander and deliver cleaner air for allergy sufferers!! The Aer1™ Allergy Plus Filter last 12 months. See back panel for other filter options.

The Filter Check Indicator is designed to remind you to check and change your filter every 11 months. To reset the Filter Check Indicator, press and hold the Power button for 3 seconds only under working mode. the Filter Check Indicator icon (🗑️) will blink 3 times on the LCD display to indicate that it has been reset.

## FOUR SPEED SETTINGS

For optimum air filtration, operate your Bionaire® air cleaner continuously on the highest (4) setting. Its rugged motor has been designed to give many years of use. For quieter operation (such as in a bedroom), select the lowest (1) setting.

## TIMER

The timer allows you to run the air cleaner at your convenience, for up to 9 hours, and automatically turns the power off when time is up, to help reduce energy costs.

## BEFORE USE

1. Carefully unpack your air cleaner.
2. Select a firm, level surface with no obstructions to the air inlets or outlets.
3. Access your Aer1™ Filter. If the filter is covered by a bag when shipped, remove plastic bag before use and place filter into unit. (Reference **FILTER REPLACEMENT INSTRUCTIONS**).

## OPERATING INSTRUCTIONS

### IMPORTANT:

- Remove all plastic bags from filters before use.
- **DO NOT POINT FILTERED AIR OUTLET TOWARDS WALL.**

### To operate your air cleaner:

1. Press the POWER button (🔌).



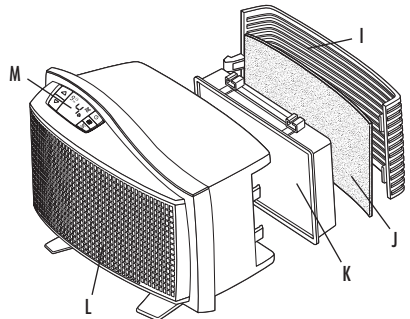
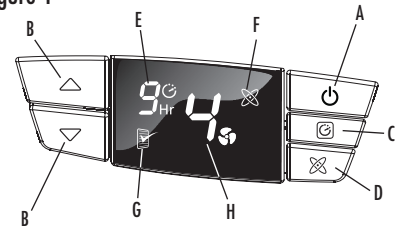

- The LCD and the indicator lights on the 5 buttons will illuminate.
  - The air cleaner will turn on at the highest (4) filtering speed, LCD will display both "4" and the fan icon (🌀).
  - Filter Check Indicator (🗑️) will blink 3 times to check the filter check timer and then go off to indicate filter life is still good.
2. You can change the filtering speed by pressing the ARROW buttons (⏪/⏩) until you reach the desired speed: 4-3-2-1.
    - The air cleaner will turn off when you press the POWER button (🔌) at any speed.
  3. Press IONIZER button (⊗) to turn ionizer ON or OFF.
    - The Ionizer icon (⊗) will appear on the LCD display when this function is activated.

Figure 1



- A. Power Button (🔌)
- B. Speed Controls (⏪/⏩)
- C. Timer Button (🕒)
- D. Ionizer Button (⊗)
- E. Timer Icon/Indicator (🕒)
- F. Ionizer Icon/Indicator (⊗)
- G. Filter Check Indicator (🗑️)
- H. Speed Setting Indicator
- I. Air Inlet Grill
- J. Washable Foam Pre-filter
- K. Aer1™ Filter
- L. Filtered Air Outlet
- M. LCD Display

# CLEANING & MAINTENANCE

- IONIZER button works in any mode except when air cleaner is turned off.
4. You may set the TIMER to automatically turn off your air cleaner when the desired time has elapsed. Press the TIMER button (  ) until you reach the desired number of hours you want the unit to operate (from 1 to 9 hours).
    - The number of hours selected and the Timer icon (  ) will light up on the LCD display and remain illuminated on the control panel.
    - When time is up, the air cleaner will turn off.
    - To CANCEL the timer, press the TIMER button (  ) and scroll through the settings until the icon disappears on the LCD display. You may also cancel the timer operation by turning the POWER button (  ) off.

6. NEVER use detergents, gasoline, glass cleaner, furniture polish, paint thinner or other household solvents to clean any part of the air cleaner.

**WARNING:** Do not allow moisture to come in contact with the main housing of the air cleaner.

## FILTER REPLACEMENT INSTRUCTIONS

### IMPORTANT:

- DO NOT attempt to wash and re-use the Aer1™ Filters.
- If the filters are enclosed in plastic bags, remove them before use.

Every few weeks, check the condition of filter. Filter life may vary, depending on filter type, air quality and usage (see below). Under normal conditions of continuous use, the Aer1™ Total Air and Odor Filter will last 4 months while the Allergen Remover, Allergy Plus and Germ Fighter Filter will last 12 months.

After approximately 11 months of operation, the Filter Check Indicator icon (  ) will illuminate on the LCD display to alert you to service the filter.

- Filters with a 4 month filter life: This Filter Check indicator is to remind you to perform maintenance to wipe your unit clean, wash the foam pre-filter and check the condition of your Aer1™ filter.
- Filters with a 12 month filter life: This Filter Check indicator is to remind you to perform annual maintenance to wipe your unit clean, wash the foam pre-filter and to replace the Aer1™ filter.

### To replace your filter:

1. Turn off and unplug the air cleaner before attempting to replace the filter.
2. Remove the filter from the unit by pulling it gently towards you.

## CLEANING AND MAINTENANCE

### Cleaning the unit:

1. Turn off and unplug the air cleaner.
2. The outside of the unit can be cleaned with a soft, clean dampened cloth.
3. The air inlet grill (see Figure 1) can be cleaned with a soft, clean damp cloth.
4. The filtered air outlet can be cleaned of dust with a small soft brush.
5. If you wish to clean the inside of the air cleaner, please only use a dry, soft cloth to wipe it down. Do not wash the Aer1™ filter. The Pre-filter (J) can be washed by using a mild dish soap and water. Rinse thoroughly. Allow to air dry completely prior to reinstalling into the Air Inlet Grill (I).

Filters can be purchased at a retailer near you, online at [www.bionairecanada.com](http://www.bionairecanada.com), or by calling 1-800-253-2764.

Air Cleaner Model #	Filter Quantity Needed	Compatible with all filter models below	Filter Description
BAP9200C-CN	1	BAPF30AT BAPF30AO BAPF350AG BAPF300AH BAPF300AP BAPF30 (A filter)	Aer1™ Total Air Filter Aer1™ Odor Filter Aer1™ Germ Filter Aer1™ Allergen Remover Filter Aer1™ Allergy Plus Filter Bionaire® "A" Filter

# FILTER REPLACEMENT TROUBLESHOOTING

3. Discard the Aer1™ filter. DO NOT attempt to clean it.
4. Remove protective plastic bags and install new Aer1™ filter into the unit.

**NOTE:** Ensure proper assembly of the filter clip to the filter. Attach the filter clip and filter assembly to the air cleaner hang tabs:

- Make sure the hang tab is securely in place. Align the clip on the top of the filter with the rails on the inside of the unit. Gently slide the filter onto the rail (see Figures 2 and 3).
- Place air inlet grill back onto unit securely.

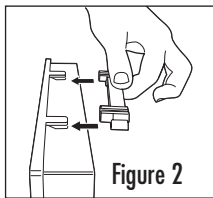

Figure 2

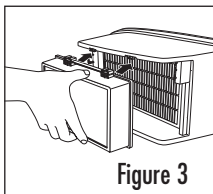

Figure 3

5. **Reset the Filter Check Indicator** by pressing the Power button (⏻) for 3 seconds.

**NOTE:** Every time you power on the air cleaner, the Filter Check Indicator icon (🔍) will blink 3 times on the LCD display. This routine test checks the current condition of the filter. If it is not time to service the filter, the icon will disappear. If not, the icon will remain lit until filter have been replaced and Filter Check Indicator (🔍) has been reset (see instructions above).

## TIPS AND TROUBLESHOOTING

Problem	Solution
<ul style="list-style-type: none"><li>• Unit will not operate</li></ul>	<ul style="list-style-type: none"><li>✓ Make sure the unit is plugged in and outlet is energized.</li><li>✓ Make sure unit turned ON.</li><li>✓ Make sure the Air Inlet Grill is not removed/closed completely.</li></ul>
<ul style="list-style-type: none"><li>• Decreased air flow</li></ul>	<ul style="list-style-type: none"><li>✓ Make sure nothing is blocking air inlet and filtered air outlets.</li><li>✓ Remove all plastic bags from filter.</li><li>✓ Check condition of filter and replace if necessary.</li></ul>
<ul style="list-style-type: none"><li>• Excessive noise</li></ul>	<ul style="list-style-type: none"><li>✓ Remove plastic bags from filter.</li><li>✓ Make sure all parts, including filter and air inlet grill, are firmly positioned in place.</li></ul>
<ul style="list-style-type: none"><li>• The filter check indicator will not reset.</li></ul>	<ul style="list-style-type: none"><li>✓ Check condition of the filter and replace if necessary.</li><li>✓ Press and hold down the Power button for 3 seconds. The Filter Check Indicator icon on the display screen should disappear.</li></ul>

## LEARNING MORE

For a wealth of information about your air cleaner and other Bionaire® products, visit our website at [www.bionairecanada.com](http://www.bionairecanada.com) or call 1-800-253-2764.

# WARRANTY INFORMATION

## 3 YEAR LIMITED WARRANTY

Sunbeam Products, Inc. doing business as Jarden Consumer Solutions or if in Canada, Sunbeam Corporation (Canada) Limited doing business as Jarden Consumer Solutions (collectively "JCS") warrants that for a period of three years from the date of purchase, this product will be free from defects in material and workmanship. JCS, at its option, will repair or replace this product or any component of the product found to be defective during the warranty period. Replacement will be made with a new or remanufactured product or component. If the product is no longer available, replacement may be made with a similar product of equal or greater value. This is your exclusive warranty. Do NOT attempt to repair or adjust any electrical or mechanical functions on this product. Doing so will void this warranty.

This warranty is valid for the original retail purchaser from the date of initial retail purchase and is not transferable. Keep the original sales receipt. Proof of purchase is required to obtain warranty performance. JCS dealers, service centers, or retail stores selling JCS products do not have the right to alter, modify or any way change the terms and conditions of this warranty.

This warranty does not cover normal wear of parts or damage resulting from any of the following: negligent use or misuse of the product, use on improper voltage or current, use contrary to the operating instructions, disassembly, repair or alteration by anyone other than JCS or an authorized JCS service center. Further, the warranty does not cover: Acts of God, such as fire, flood, hurricanes and tornadoes.

### **What are the limits on JCS's Liability?**

JCS shall not be liable for any incidental or consequential damages caused by the breach of any express, implied or statutory warranty or condition.

Except to the extent prohibited by applicable law, any implied warranty or condition of merchantability or fitness for a particular purpose is limited in duration to the duration of the above warranty.

JCS disclaims all other warranties, conditions or representations, express, implied, statutory or otherwise.

JCS shall not be liable for any damages of any kind resulting from the purchase, use or misuse of, or inability to use the product including incidental, special, consequential or similar damages or loss of profits, or for any breach of contract, fundamental or otherwise, or for any claim brought against purchaser by any other party.

Some provinces, states or jurisdictions do not allow the exclusion or limitation of incidental or consequential damages or limitations on how long an implied warranty lasts, so the above limitations or exclusion may not apply to you.

This warranty gives you specific legal rights, and you may also have other rights that vary from province to province, state to state or jurisdiction to jurisdiction.

### **How to Obtain Warranty Service**

#### In the U.S.A.

If you have any questions regarding this warranty or would like to obtain warranty service, please call 1-800-253-2764 and a convenient service center address will be provided to you.

#### In Canada

If you have any questions regarding this warranty or would like to obtain warranty service, please call 1-800-253-2764 and a convenient service center address will be provided to you.

In the U.S.A., this warranty is offered by Sunbeam Products, Inc. doing business as Jarden Consumer Solutions located in Boca Raton, Florida 33431. In Canada, this warranty is offered by Sunbeam Corporation (Canada) Limited doing business as Jarden Consumer Solutions, located at 20 B Hereford Street, Brampton, Ontario L6Y 0M1. If you have any other problem or claim in connection with this product, please write our Consumer Service Department. **PLEASE DO NOT RETURN THIS PRODUCT TO ANY OF THESE ADDRESSES OR TO THE PLACE OF PURCHASE.**

# AER1™ FILTER SERIES

**Congratulations! Your new air purifier is equipped with the new and improved Aer1™ Allergy Plus Filter.**

Filter Type	Technology	Consumer Benefit
Total Air	99% HEPA-Type technology. Infused with Arm & Hammer® baking soda.	Ideal for dust reduction. Delivers 30% better air quality.
Odor Eliminator	10 times the odor fighting power. Contains Arm & Hammer® baking soda, carbon and zeolite for odor control.	Ideal for eliminating odors from pets, tobacco smoke and cooking fumes.
Allergen Remover	99.97% True HEPA technology. Removes up to 99.97% of particales passing through the filter such as pollen, dust, mold and dander.	Ideal for allergy sufferers.
<b>THIS UNIT COMES WITH</b> Allergy Plus	99.99% True HEPA technology. Helps remove up to 99.99% of particles passing though the filter such as pollen, dust, mold and dander.	Ideal for allergy sufferers.
Germ Fighter with Allergen Remover	99.97% True HEPA technology. Infused with silver technology.	Helps reduce viruses and bacteria as well as ideal for allergy sufferers.



© 2013 Sunbeam Products, Inc. doing business as Jarden Consumer Solutions. All rights reserved. Imported and distributed by Sunbeam Corporation (Canada) Limited doing business as Jarden Consumer Solutions, 20B Hereford Street, Brampton, Ontario L6Y 0M1.

The ARM & HAMMER® name, logo and associated marks are trademarks of Church & Dwight Co., Inc. and are used under license by Sunbeam Products, Inc.

Printed In China